

Mangar Camel and Eagle Quick Start Guide

See '**BATTERY NOTE**' page 2 before proceeding. Please read the full product user instructions for the Airflo 24 and Lifting Cushion.

1

Connect hoses:

1 = 1

2 = 2

3 = 3

4 = 4

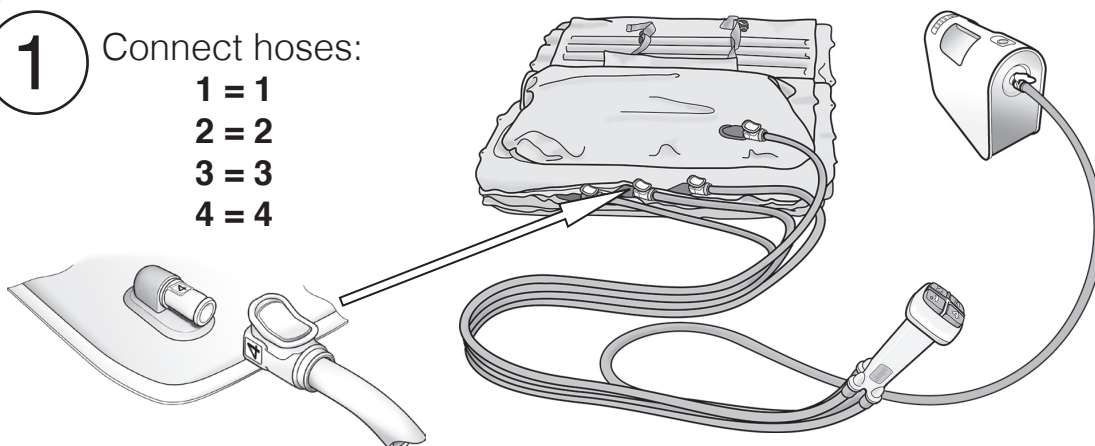

2

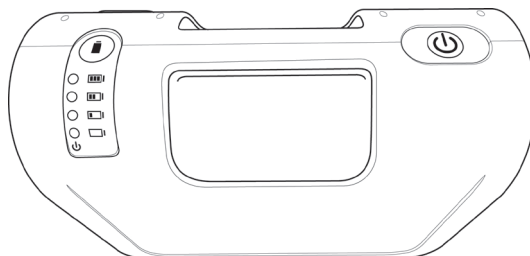

Momentarily press the power button to switch 'On'.

3

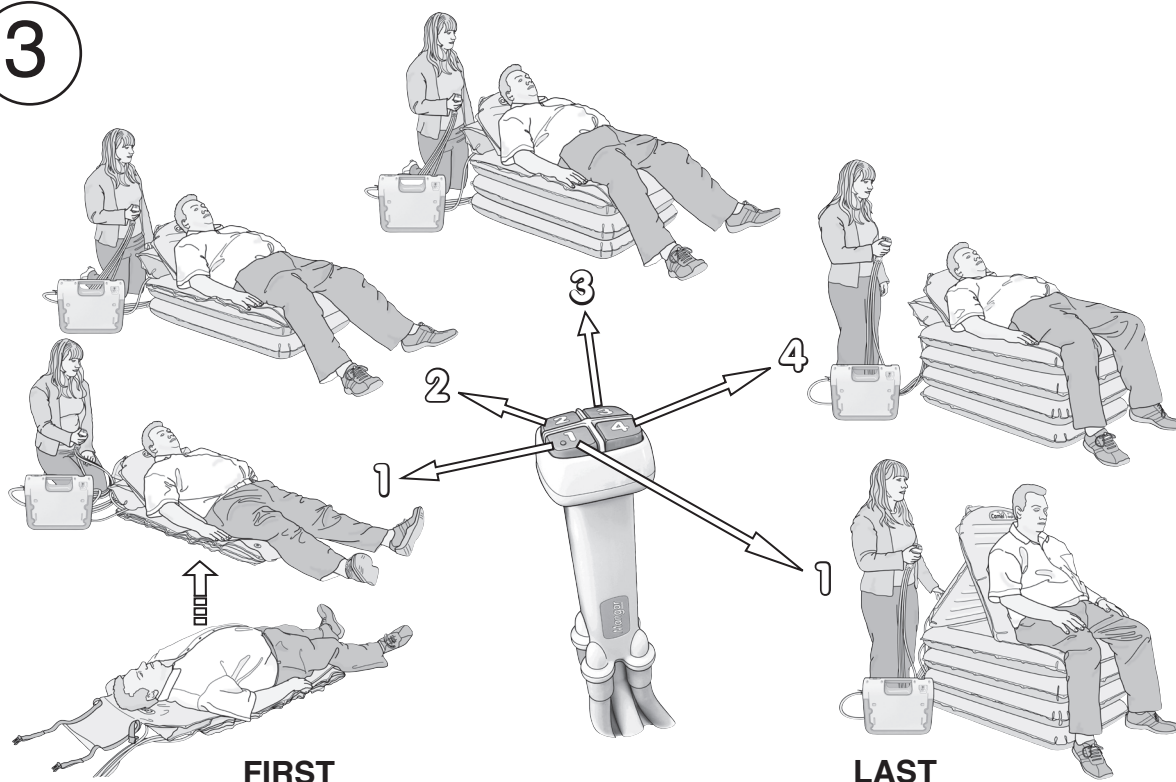

Mangar Camel and Eagle Quick Start Guide

WARNING: While in use, never allow a section to become partially deflated while any sections above it are inflated. Sections must always be fully inflated from the bottom up, in sequence, in order to maintain stability.

Cleaning and Disinfecting

The Camel/Eagle should be fully inflated and pre-cleaned by washing with detergent and water, thoroughly rinsed and then disinfected using a 1:10 solution of household liquid bleach and water (1 part bleach to 10 parts cold water). Leave the solution on the Camel/Eagle for approximately 10 minutes before thoroughly rinsing off with clean cold water. Allow to air dry before storage. Do not dry using hot air.

BATTERY NOTE: Charge for 12 hours before first use. Before each use, check the battery charge state by pressing the 'Battery State Indicator' button (*please read full Airflo 24 User Instructions*).

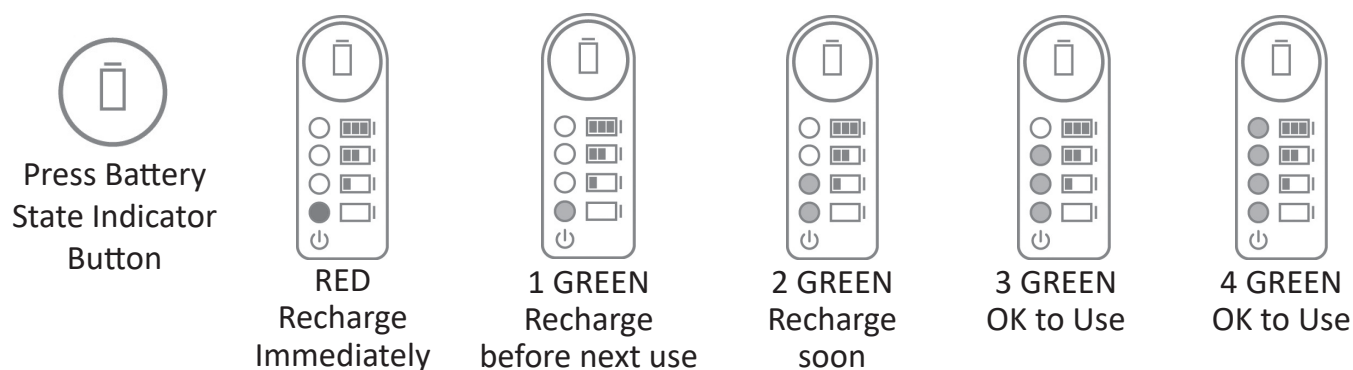

WinnCare

Presteigne, Powys
Wales, UK, LD8 2UF
Tel: +44(0)1544 267674
enquiries@winnCare.uk
www.winnCare.uk
MI0484 Issue 2



Joerns Healthcare

General: 800.826.0270
Canada: 866.546.1151
info@joerns.com
www.joerns.com
6240093 RevB • 001093