

User Instruction Manual

Hoyer® Comfort Sling

(Including Comfort Pad® and Securi3 Clip System)

To avoid injury, read user manual prior to use.

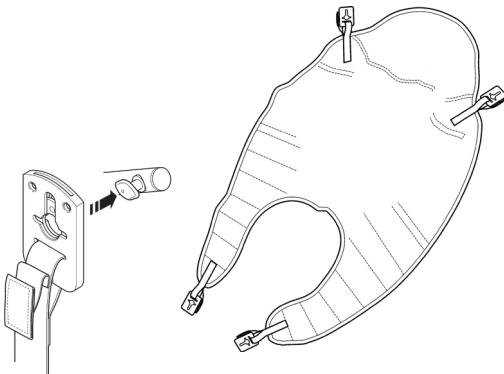

Introduction

The Comfort sling is an easy fit, contoured sling designed to accommodate 85-90% of clients. It is used in conjunction with the 4-point spreader bar which is designed to position patients from either a seated or reclined position. The sling is available in five sizes - extra large, large, medium, small and extra small.

Statement of Intended Use

A sling is an item of moving and handling equipment that is used with a mechanical lift in order to facilitate the transfer of a patient. It comprises a specially designed and constructed piece of fabric that is placed under and/or around a patient before being attached to the spreader bar/cradle of a lift to raise, transfer and lower the patient. When selected and used correctly, a sling and lift combination will achieve a safer transfer and reduce the risks associated with manual handling.

It is the responsibility of a competent person to conduct a thorough risk assessment prior to using any sling, to ensure that the sling choice, method of positioning in the sling and procedure for transfer has been correctly determined for the patient. For further guidance, please contact your authorized Hoyer service provider or Joerns Healthcare directly.

FOR USE WITH PASSIVE LIFTS ONLY.

Expected Service Life

The expected service life of a Hoyer sling will vary dependent on use and following the care and washing instructions provided in the user guide. Factors such as wash temperature, detergents, frequency of use and patient weight will impact on the lifetime of your sling. Joerns Healthcare recommend that slings are checked each and every time prior to use to ensure the safety of the patient. Bleached, torn, cut, frayed or broken slings are unsafe and must be discarded and replaced.

WARNING

- **HOYER RECOMMENDS THE USE OF GENUINE HOYER SLINGS.** Hoyer slings and lifters are not designed to be interchangeable with other manufacturer's products. Using other manufacturer's products on Hoyer products is potentially unsafe and could result in serious injury to patient and/or caregiver.
- For the safety of the patient and carer; before using a sling a full risk assessment must be conducted to ensure that the correct sling choice, method of positioning in the sling and procedure for transfer has been determined for the patient.
- **CHECK** sling and stitching before each use. Using bleached, torn, cut, frayed or broken slings is unsafe and could result in serious injury or death to the patient.
- **DO NOT** alter slings. Destroy and discard worn slings.
- **NEVER** leave a patient unattended.
- **DO NOT** exceed the rated capacity of the sling or lift.
- **DO NOT** attempt to re-position a patient by pulling on the sling loops.

Fitting the Sling from a Seated Position

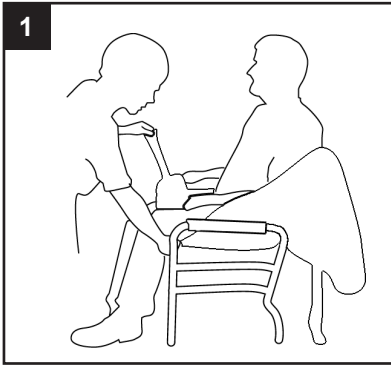

The comfort sling is fitted to the patient in the traditional way. Fitting from the seated position requires the carer to raise the client's leg and feed the leg support piece under and up between the legs. Repeat this procedure for the other leg. Ensure the sling is not twisted or creased under the thigh. Bring both leg pieces together and feed through the modesty strap.

Position the rear section of the sling up and around the shoulders and head, the client is then ready for lifting.

Fitting the Sling from a Lying Position

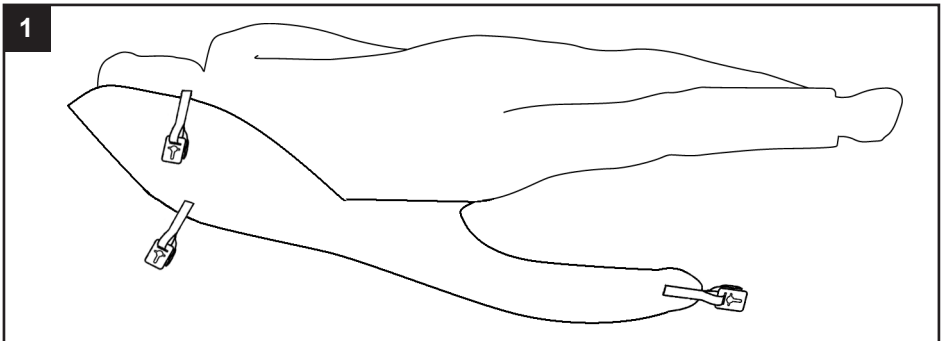

Draw sheet roll the client onto the sling, ensuring that the top of the commode aperture is at the base of the spine. Position the spreader bar as shown opposite and the client is ready for lifting.

GOLDEN TIPS

- 1. THE CLIENT'S POSTURE CAN BE ALTERED BY PUSHING DOWN ON SPREADER BAR PIVOT HANDLE (SEE OPPOSITE).**
- 2. ATTACH SECURI3 CLIPS TO THE SPREADER BAR AS DESCRIBED OPPOSITE.**
- 3. ENSURE ALL GREEN SAFETY LOOPS ARE VISIBLE BEFORE LIFTING.**

Fitting the Sling to the 4-Point Spreader Bar

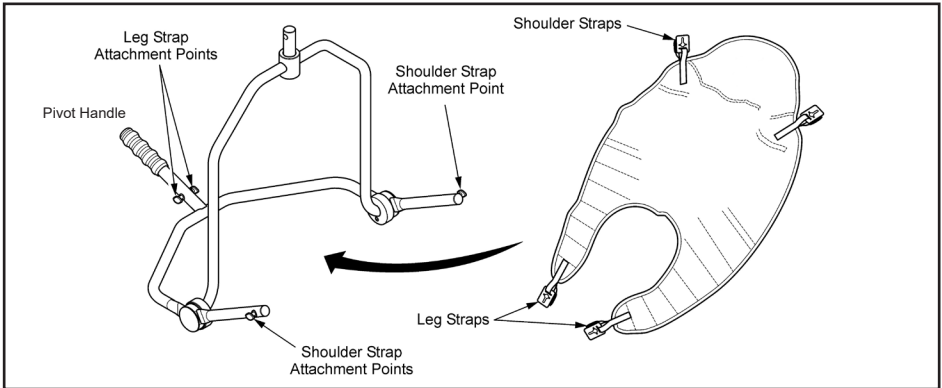

When fitted to the patient, the sling is connected to the 4 point spreader bar by using the Securi3 clip system (step by step guide as follows). To remove, simply reverse this procedure.

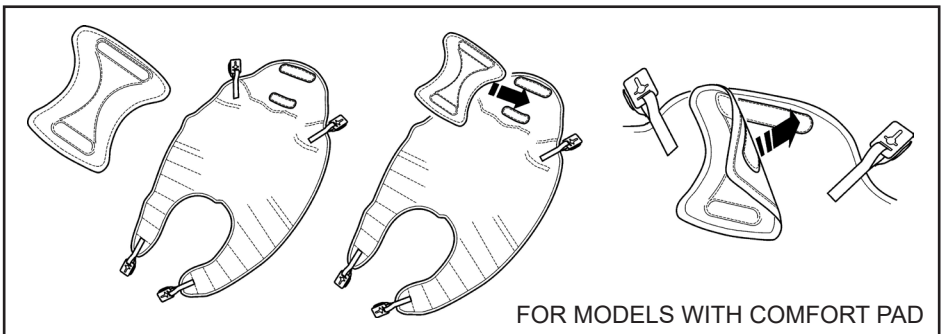
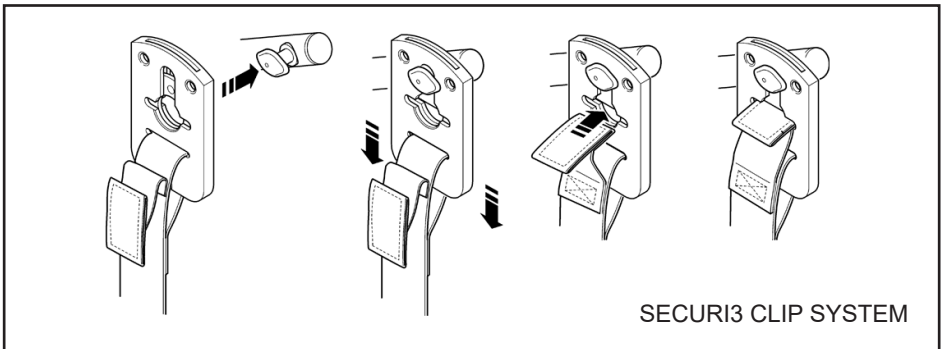

The Comfort Pad must be applied as it provides additional comfort and support to the client. Do not lift without the Comfort Pad correctly in position. The Comfort Pad is available in different thicknesses providing increased levels of support/comfort.

Technical Specifications

STANDARD	BS EN ISO 10535
----------	-----------------

Sizing & Safe Working Load

SIZE	Comfort (Polyester)	Comfort Padded (Polyester)	Comfort (Net)
EXTRA SMALL (BROWN)	500lbs / 227kg	500lbs / 227kg	500lbs / 227kg
SMALL (RED)	500lbs / 227kg	500lbs / 227kg	500lbs / 227kg
MEDIUM (YELLOW)	500lbs / 227kg	500lbs / 227kg	500lbs / 227kg
LARGE (GREEN)	500lbs / 227kg	500lbs / 227kg	500lbs / 227kg
EXTRA LARGE (BLUE)	500lbs / 227kg	500lbs / 227kg	500lbs / 227kg

Washing Instructions



DO NOT EXCEED 185°F water temperature. Machine wash in warm water.



DO NOT wash with bleach. Bleach will damage the sling's material and make it unsafe for use.



Cool tumble dry, air dry or dry at very low temperature.



DO NOT dry clean.

⚠ WARNING

Slings can suffer damage during washing and drying and should be checked carefully before each use.

PLEASE NOTE: Additional slings are available to meet individual patient needs. We advise that you always seek the advice of a trained clinician, authorized Hoyer distributor or Joerns Healthcare prior to purchase or use.

THIS PAGE IS INTENTIONALLY BLANK

THIS PAGE IS INTENTIONALLY BLANK

